

Vroom[®] Retract Vac[®]

Installation & Operating Instructions

Attention Installer: Please be sure this manual and warranty information are left with the customer when installation is complete.



512 West Gorgas Street ■ Louisville, OH 44641-3912
www.vroomretractvac.com

Dealer Name _____

Dealer Phone _____

TABLE OF CONTENTS:

General Information	3
Planning the Installation	3
New Construction Rough-in	4
Retro-fit Installation / New Construction Finish	4
Shortening the Hose	6
Operation	7
Storing the Hose	7
Limited Warranty	8

INCLUDED IN BOX:

- Vroom Retract Vac Valve
- Hose
- 6" Clear Tubing
- Hardware Bag
- Reducer Coupling

OTHER ITEMS NEEDED:

- Fittings to complete tube run
- Tubing
- PVC Glue
- Low Voltage Wire
- Tubing Cutter
- Deburr Tool
- Level

GENERAL INFORMATION

The Vroom Retractable Vac® is a retractable hose system designed for garages to quickly and conveniently clean everyday dry messes. With its extensive hose reach, the Vroom Retractable Vac cleans both inside and outside the garage. The Vroom Retractable Vac is perfect for cleaning vehicles, workbenches, floors, shelves, ceilings and more.

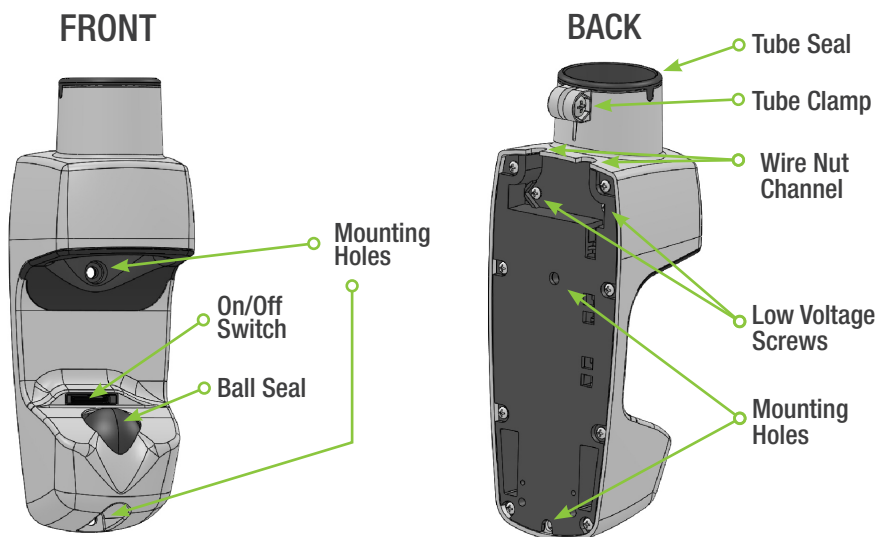

INSTALLATION

Planning the Installation

The Vroom Retractable Vac valve is surface mounted so the hose can either retract up or down. It is recommended to install the valve near the garage door so the hose reaches both inside and outside the garage to provide maximum reach and coverage. Select a location that is both convenient to access and provides a clear path to connect the PVC tubing to the trunk line of the vacuum power unit.

The hose is stored inside the tubing, so the tube run will need to be at least 5' longer than the hose, to allow for possible stretch. It is recommended that a reducer coupling be installed after the hose storage area ends. Be sure to only use long radius elbows that are used with retractable hose valves within the hose storage area, standard central vacuum fittings may be used after the storage area of the tube run.

New Construction Rough-in

The tubing should be roughed-in so it comes down through the ceiling directly above the intended valve location. Extend the tubing approximately 6-inches below where the finished garage ceiling will be, do not glue, then finish the connection when the valve is installed after drywall. The low voltage wire should be left long enough to finish the valve, approximately 8-feet. The rest of the tubing run from the ceiling to the valve will be surface mounted when finished.

Retro-fit Installation / New Construction Finish

NOTE: Locate the Vroom Retract Vac valve at approximately the same height as a light switch if hose retracts up. If the hose retracts down, mount it at approximately the height of an electrical outlet.

1. Using a level held against top of tube seal, mark the mounting holes for the valve at desired location.
2. If installing on drywall, sink included self-drilling anchors at marked locations. Temporarily mount valve using one screw into drywall anchor or directly into stud to hold during tubing installation.
3. Insert the 6-inch long piece of clear tubing into the top of the valve. The tubing should be completely inserted 1-1/2-inches into the valve tube seal. [FIG. 2]
4. Slightly tighten the tube clamp onto the clear tubing. NOTE: The tube clamp features a reversible nut and bolt which allows the bolt to be accessed from either side. [FIG. 3]
5. Complete the installation of the hose storage area using long radius elbows and a tubing cutter. Make sure to deburr the ends of the tubing.
6. Install the recommended reducer coupling at the end of the hose storage area, prior to the first standard fitting (at least 5-foot longer than the hose).
7. Remove the screw temporarily holding the valve in place, and gently rotate the valve to access the low voltage wires and screws. Attach the wires from the valve to the trunk line wire and secure to the valve using the ring terminals or strip the end of the wires and use the supplied wire nuts. [FIG. 4]
8. Rotate the valve back forward facing and permanently mount the valve to the wall using the two screws provided. Tighten tube clamp to create vacuum seal.

9. Turn the system on using the on/off switch on the valve and install the hose by pushing the hose cuff end into the valve until it "clicks" and stops. Rotate the hose cuff 90-degrees to the left and partially cover the hose end with hand. The hose will release and begin retracting into the tubing.
10. Once the hose is fully retracted, push the hose handle onto the rubber ball and the vacuum will automatically turn off and seal the valve.

NOTE: If a shorter hose is needed, the hose must be shortened on the handle end, not the cuff end. Please refer to "Shortening the Hose" section on the next page.

FIG. 1

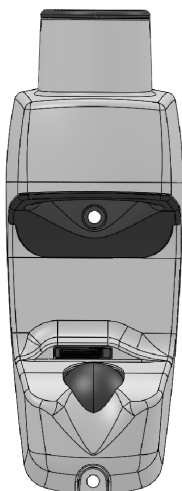

FIG. 2

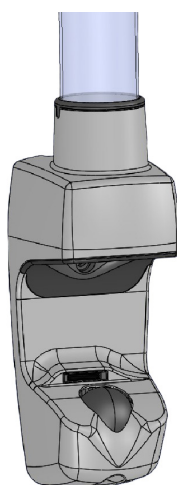

FIG. 3

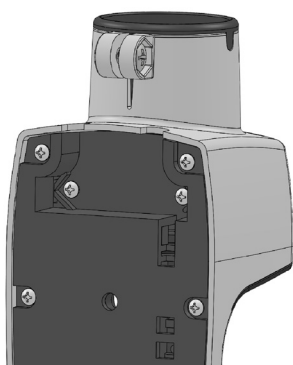
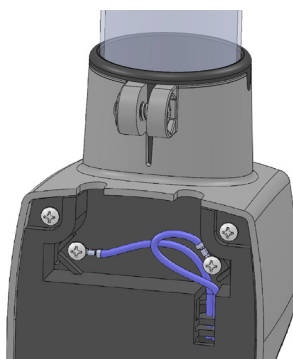

FIG. 4



SHORTENING THE HOSE

1. Locate the tabs on each side of the handle's underside. (FIG. 1)
2. Use a screwdriver or fingernail to press tabs in towards the hose to release and remove the handle. (FIG. 1)
3. Keep the black locking collar on the hose. (FIG. 2)
4. Remove the clear barbed insert by pulling outward and unscrewing (left-hand thread) or carefully slit hose below insert with razor knife to remove. (FIG. 2)
5. Shorten the hose as needed.
6. Push the barbed insert into the hose, then slide the locking collar into place. (FIG. 2)
7. Attach the nozzle by re-engaging the tabs on each side (push outwards)—you should hear a “click.” (FIG. 3)

FIG. 1



FIG. 2



FIG. 3



OPERATION

1. Pull the hose handle out, down and away from the valve.
2. Continue pulling the hose until you feel the end of the hose reach the valve. You will see the hose nearing the end through the clear tubing section. You will hear or feel the hose cuff click into its locked position. (FIG. 1)
3. Turn the system on using the on/off switch on the valve to begin vacuuming. The system can be used to vacuum dry messes. Optional attachments may be used on the hose end to meet various cleaning needs.

Storing the Hose

1. With the vacuum on, unlock the hose end by grabbing the hose approximately 8-inches from the valve and rotate the hose to the left until it releases. (FIG. 1)
2. Partially cover the handle end with hand to retract the hose into the tubing. (FIG. 2)
3. Once fully retracted, push the handle end onto the rubber ball and the system will automatically turn off. (FIG. 3)

NOTE: If the hose accidentally pulls completely out, refer to step 8 in Installation.

FIG. 1



FIG. 2



FIG. 3





VROOM RETRACT VAC WARRANTY

All permanently installed components of the Vroom Retract Vac Valve are warranted to be free from defects in material and workmanship for a period of three (3) years under normal use and care as long as the original purchaser owns the home of the original installation or until the system is removed from its original installation location, whichever occurs first. In the event of a defect in a permanently installed component of the Vroom Retract Vac Valve, contact an Authorized Dealer to ensure the best quality repair and servicing. Upon determination of a defect with a permanently installed component, H-P Products, Inc. will provide any replacement parts to the Authorized Dealer at no cost to you. Repair or replacement of any permanently installed defective part or parts shall be at the labor cost billed to you by the Authorized Dealer.

The Vroom Retract Vac Hose is warranted to be free from defects in material and workmanship under normal use and care for a period of three (3) years from original date of consumer purchase. In the event of a defect in the Vroom Retract Vac Hose, it will be repaired or replaced, at H-P Products' option, at an Authorized Dealer's location at no cost to you.

Limitations for Non-Residential Applications

In non-residential applications both permanently installed components of the Vroom Retract Vac Valve and the Vroom Retract Vac Hose are warranted to be free from defects in material and workmanship for ninety (90) days from original date of purchase.

THIS WARRANTY IS A SOLE AND EXCLUSIVE WARRANTY. ALL OTHER WARRANTIES INCLUDING IMPLIED WARRANTIES OF MERCHANTABILITY OR FITNESS FOR A PARTICULAR PURPOSE ARE EXCLUDED. THIS WARRANTY COVERS ONLY LIABILITY AND RESPONSIBILITY DESCRIBED HEREIN AND THERE IS NO LIABILITY FOR ANY CONSEQUENTIAL, INCIDENTAL OR SPECIAL DAMAGES ARISING FROM THE USE OF THIS SYSTEM.

Some states do not allow the exclusion or limitation of warranties or limitation of incidental or consequential damages, so the above exclusion may not apply to you. This warranty gives you specific legal rights and you may have other rights that vary from state to state.



H-P Products
Central Vacuums

512 W. Gorgas St., Louisville, Ohio 44641
www.vroomretractvac.com